

ELEVATION
(SCALE 1:10)

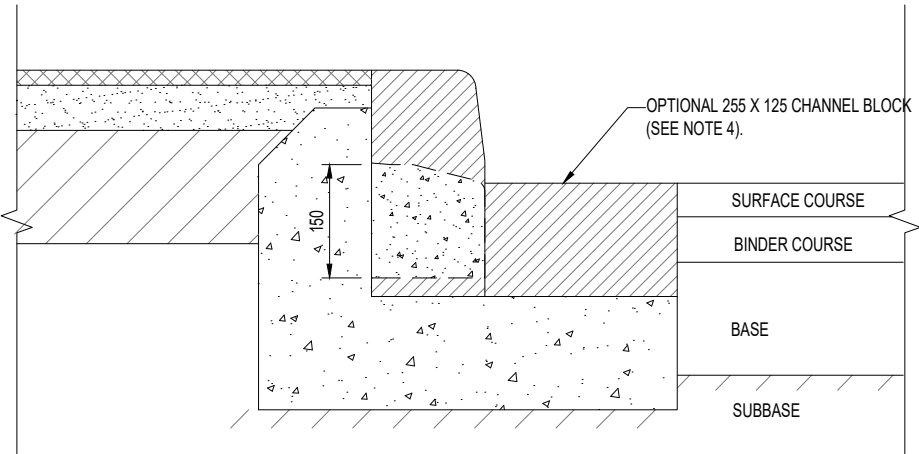

SECTION A-A
(SCALE 1:10)

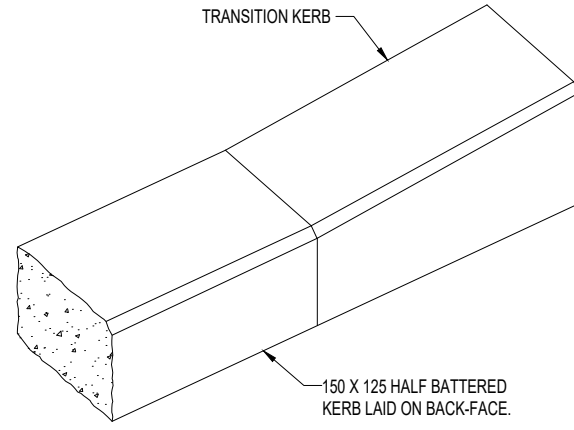

KERB DETAIL
(SCALE 1:10)

NOTES:

1. ALL DIMENSIONS ARE IN MILLIMETRES UNLESS OTHERWISE STATED.
2. THIS DRAWING SHALL BE READ IN CONJUNCTION WITH HST/1100/002.
3. THE 150 X 125 HALF BATTER KERB WAS FORMERLY DESIGNATED AS A PC9 ON BS EN 1340:2003.
4. AT THE START OF A CYCLEWAY OR OTHER LOCATIONS WHERE CYCLISTS WILL BE JOINING THE CYCLEWAY AT ACUTE ANGLES THE NUMBER OF FLUSH KERBS SHOULD BE INCREASED TO A MINIMUM OF FOUR.
5. WHERE SPECIFIED, ON NEW CARRIAGEWAYS A 255 X 125 CHANNEL BLOCK TO BE LAID IN THE CARRIAGEWAY ACROSS THE WIDTH OF THE CROSSING. FOUNDATION AS PER DRG NO HST/1100/002.



COUNTY HALL
Pegs Lane
Hertford, Herts
SG13 8DN
Phone: 01992 555555

Revisions

- A - FEB 20 REVISED DETAIL
- B -
- C -

Drawing Title

FLUSH DROPPED CROSSING
TYPE B

Dwg No: **HST/1100/014**

Scale at A4 : 1:10

Drawn	YS	Approved	HH	Revised	A
Checked	KK	Date	JULY 11	Date	FEB 20